

## 1999 Toyota RAV4

1998-99 ENGINE COOLING Drive Belt Routing & Adjustment - Land Cruiser, RAV4, Sienna, Tacoma, T100 & 4Runner

### 1998-99 ENGINE COOLING

Drive Belt Routing & Adjustment - Land Cruiser, RAV4, Sienna, Tacoma, T100 & 4Runner

#### DRIVE BELT ROUTING

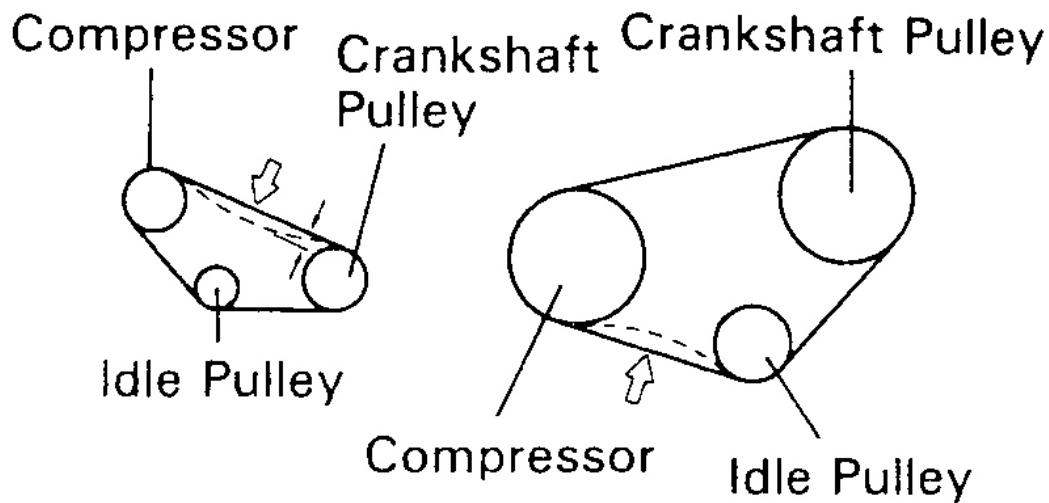

G00122201

**Fig. 1: Identifying Drive Belt Routing (4Runner, T-100 & Tacoma)**  
Courtesy of TOYOTA MOTOR SALES, U.S.A., INC.

## 1999 Toyota RAV4

1998-99 ENGINE COOLING Drive Belt Routing & Adjustment - Land Cruiser, RAV4, Sienna, Tacoma, T100 & 4Runner

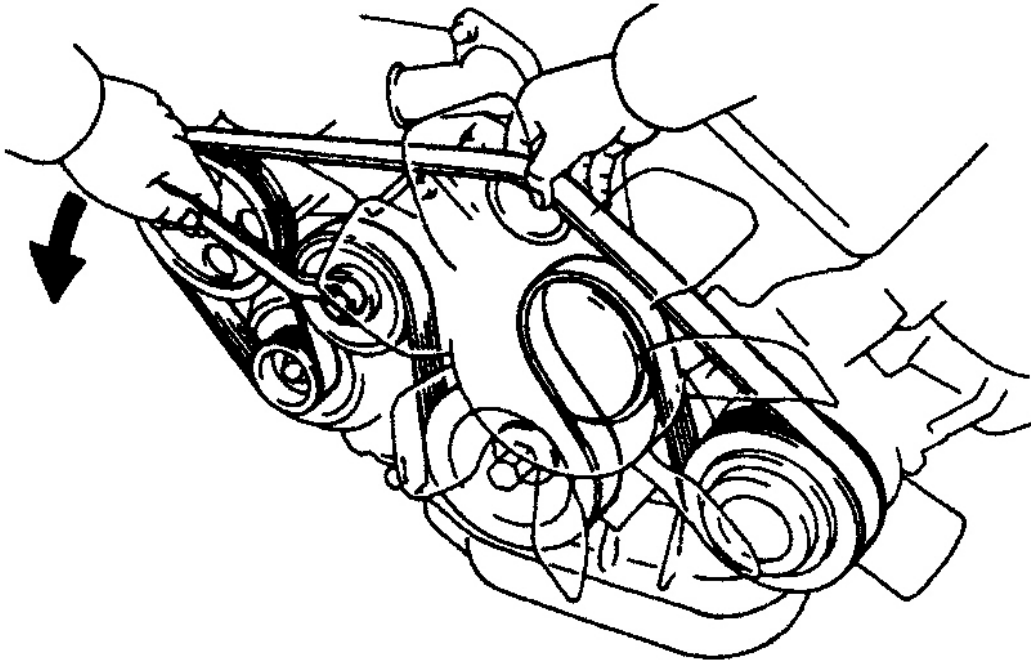

G00122211

**Fig. 2: Identifying Drive Belt Routing (Land Cruiser)**  
Courtesy of TOYOTA MOTOR SALES, U.S.A., INC.

## 1999 Toyota RAV4

1998-99 ENGINE COOLING Drive Belt Routing & Adjustment - Land Cruiser, RAV4, Sienna, Tacoma, T100 & 4Runner

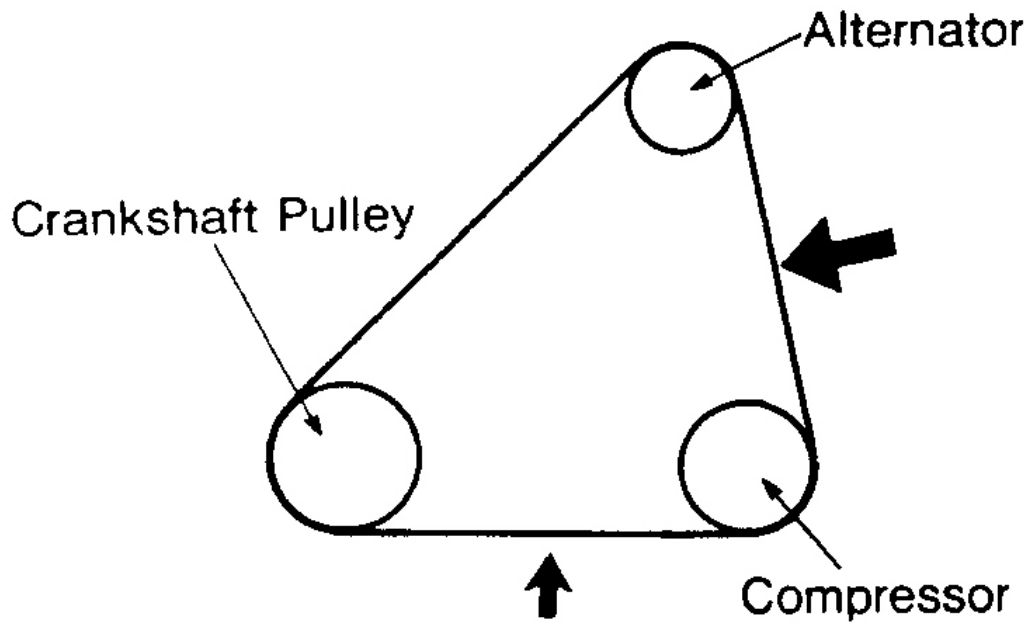

G00122205

**Fig. 3: Identifying Drive Belt Routing (RAV4)**  
Courtesy of TOYOTA MOTOR SALES, U.S.A., INC.

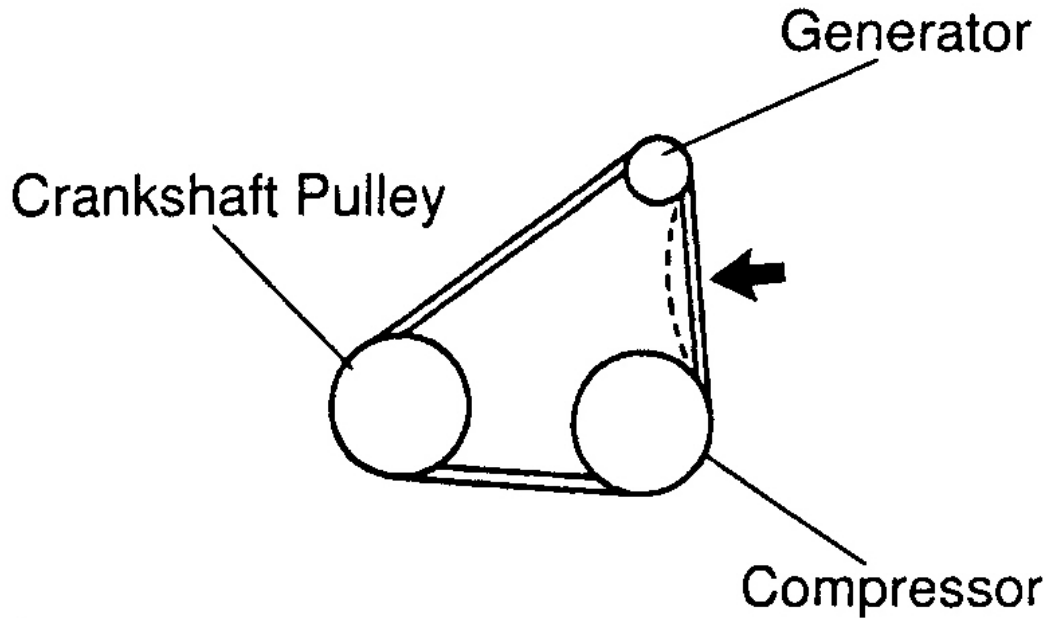

G00122212

**Fig. 4: Identifying Drive Belt Routing (Sienna)**

Courtesy of TOYOTA MOTOR SALES, U.S.A., INC.

## DRIVE BELT TENSION SPECIFICATIONS

**NOTE:** Cracks on the rib side of a drive belt are considered acceptable. If the drive belt has chunks missing from the ribs, it should be replaced. Using a belt tension gauge, measure the belt tension. If the belt tension is not as specified, adjust it.

Visually check the drive belt for excessive wear, frayed cords, etc. If any defect is found, replace the drive belt.

## 1999 Toyota RAV4

1998-99 ENGINE COOLING Drive Belt Routing & Adjustment - Land Cruiser, RAV4, Sienna, Tacoma, T100 & 4Runner

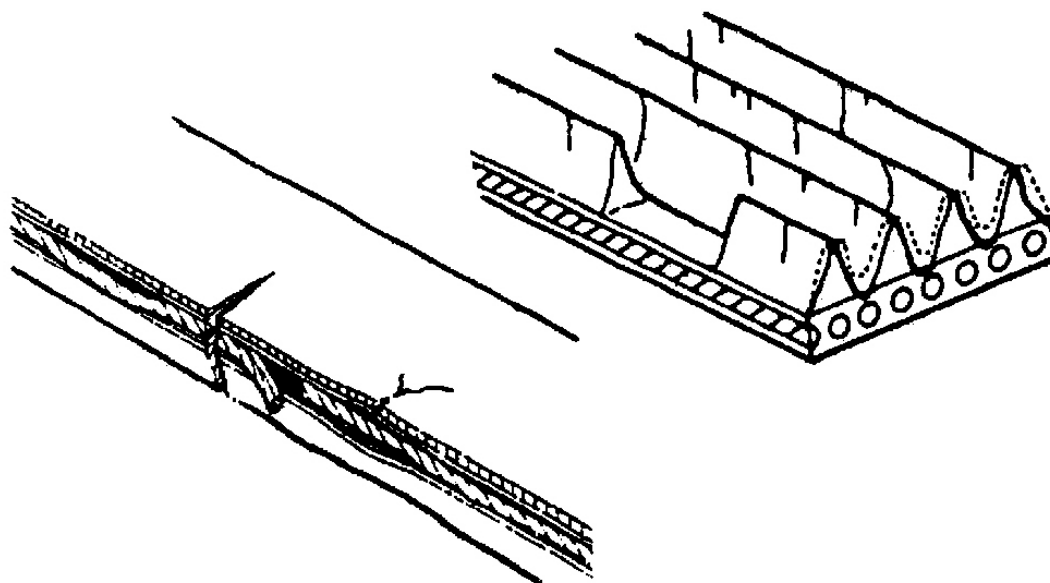

G00113695

**Fig. 5: Identifying Drive Belt Damage**

Courtesy of TOYOTA MOTOR SALES, U.S.A., INC.

**NOTE:** "New belt" refers to a belt which has been used for less than 5 minutes on a running engine. "Used belt" refers to a belt which has been used on a running engine for 5 minutes or more.

After installing a belt, check that it fits properly in the ribbed grooves. Check with your hand to confirm that the belt has not slipped out of the groove on the bottom of the pulley. After installing a new belt, run the engine for about 5 minutes and recheck the belt tension.

## 1999 Toyota RAV4

1998-99 ENGINE COOLING Drive Belt Routing & Adjustment - Land Cruiser, RAV4, Sienna, Tacoma, T100 & 4Runner



**CORRECT**



**WRONG**



**WRONG**

G00113696

**Fig. 6: Checking Drive Belt Alignment**

Courtesy of TOYOTA MOTOR SALES, U.S.A., INC.

### 4RUNNER, T-100 & TACOMA (1999)

**NOTE:** Drive belt tension is measured using Borroughs BT-33-73F or DENSO BTG-20 belt tension gauge. See [Fig. 8](#) .

### BELT TENSION

Application	Lbs.
Alternator	
2RZ-FE & 3RZ-FE Engine	
New	117-170
Used	66-88
5VZ-FE Engine	
New	140-180
Used	80-120
A/C Compressor	
New	135-185
Used	80-120
Power Steering	
New	135-180
Used	85-120

### LAND CRUISER

**NOTE:** This vehicle is equipped with a auto tensioner. No adjustment is needed. Check that the tension is within "A" range on the auto tensioner scale. If the tension is

## 1999 Toyota RAV4

1998-99 ENGINE COOLING Drive Belt Routing & Adjustment - Land Cruiser, RAV4, Sienna, Tacoma, T100 & 4Runner

not within the "A" range on the scale, replace the belt with a new one. See Fig. 7 . When replacing the drive belt with a new one, the belt's tension should be within the "B" range on the belt tensioner scale.

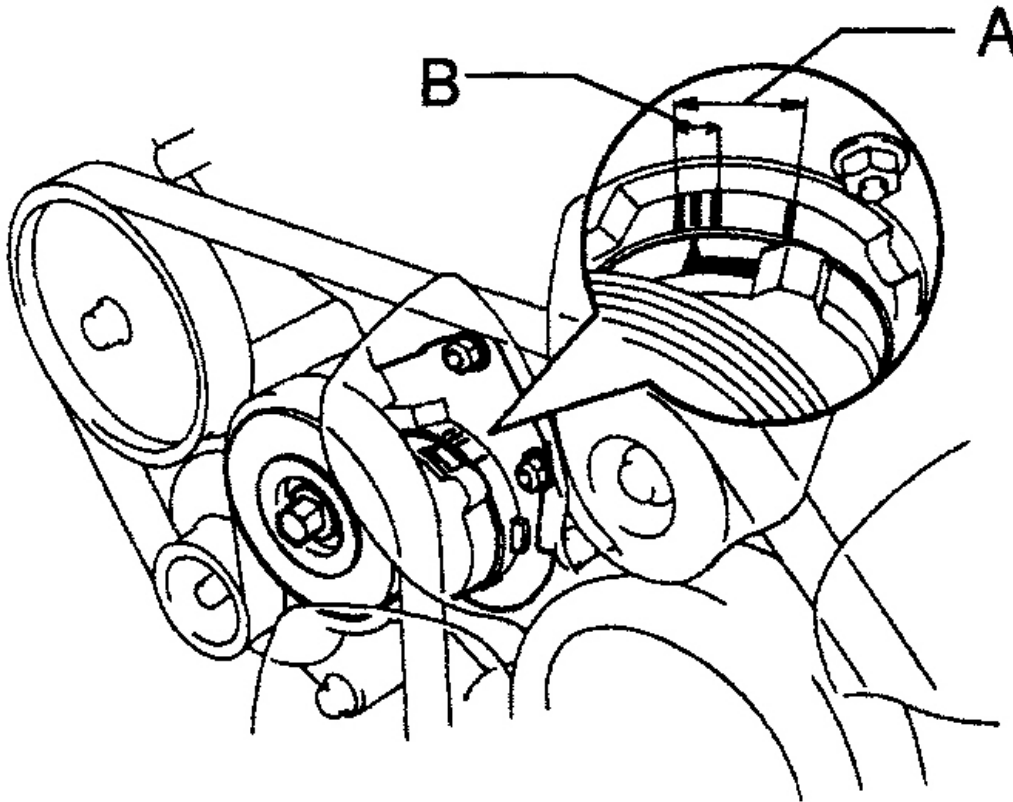

G00122210

**Fig. 7: Identifying Belt Tensioner Test**

Courtesy of TOYOTA MOTOR SALES, U.S.A., INC.

### RAV4

**NOTE:** Drive belt tension is measured using Borroughs BT-33-73F or DENSO BTG-20 belt tension gauge. See Fig. 8 .

### BELT TENSION

Application	Lbs.
Alternator	
With A/C	

## 1999 Toyota RAV4

1998-99 ENGINE COOLING Drive Belt Routing & Adjustment - Land Cruiser, RAV4, Sienna, Tacoma, T100 & 4Runner

New	140-190
Used	100-120
Without A/C	
New	100-150
Used	75-115
A/C Compressor	
New	135-185
Used	80-120
Power Steering	
New	95-145
Used	60-100

## SIENNA

**NOTE:** Drive belt tension is measured using Borroughs BT-33-73F or DENSO BTG-20 belt tension gauge. See Fig. 8 .

### BELT TENSION

Application	Lbs.
Alternator	
New	170-180
Used	95-135
A/C Compressor	
New	139-191
Used	66-110
Power Steering	
New	150-185
Used	95-135

## TACOMA (1998)

**NOTE:** Drive belt tension is measured using Borroughs BT-33-73F or DENSO BTG-20 belt tension gauge. See Fig. 8 .

### BELT TENSION

Application	Lbs.
Alternator	
2RZ-FE & 3RZ-FE Engine	
New	116-169
Used	66-88
5VZ-FE Engine	



## 1999 Toyota RAV4

1998-99 ENGINE COOLING Drive Belt Routing & Adjustment - Land Cruiser, RAV4, Sienna, Tacoma, T100 & 4Runner

New	140-180
Used	80-120
A/C Compresor	
New	135-185
Used	80-120
Power Steering	
New	135-180
Used	85-120

## SPECIAL TOOLS

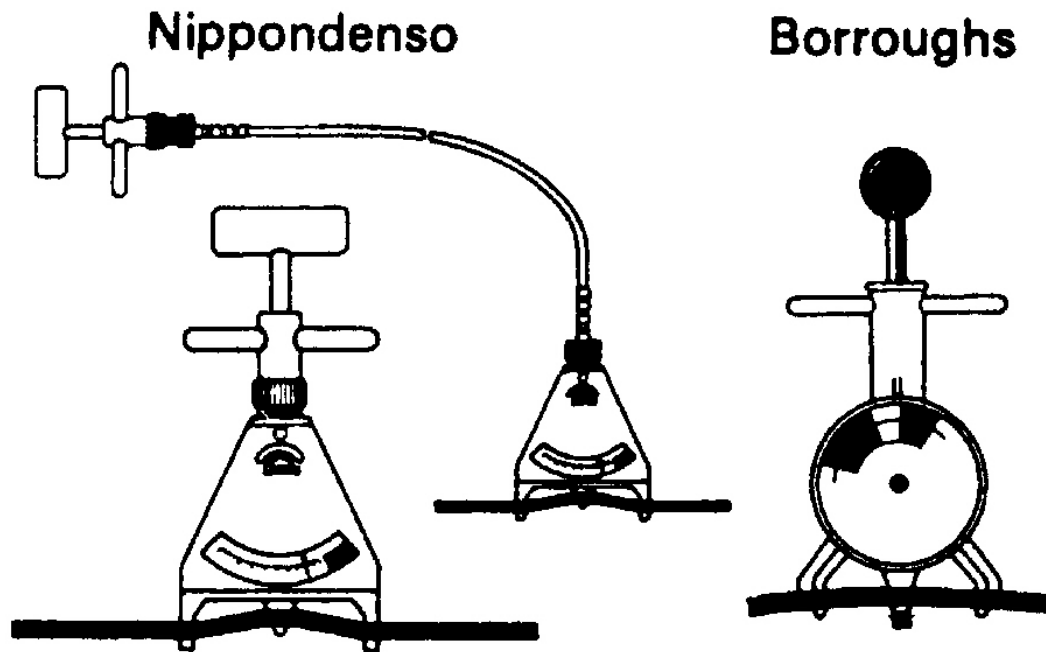

G00122191

**Fig. 8: Identifying Special Tools**  
Courtesy of TOYOTA MOTOR SALES, U.S.A., INC.